



**MODEL 6000**  
**OWNER'S MANUAL**

[www.curbroller.com](http://www.curbroller.com)  
785-467-3132



# Table of Contents

Introduction .....	1
Upon Receipt .....	1
Manufacturer's Notice .....	1
Specifications .....	2
Batt Screed Package .....	2
Safety .....	3
Assembly .....	5
Operation .....	6
Operation Technique .....	7
Cleanup and Maintenance .....	7
Cleanup .....	7
Maintenance .....	7
Troubleshooting .....	8
Trigger Sticks .....	8
Short Battery Life .....	8
Excessive Shaking / Pipe Jumping .....	9
Access Door Won't Stay Shut .....	9
Drive End Falls In Concrete / Won't Stand .....	9
Nothing Happens When Trigger Is Pulled .....	10
Parts .....	11
Batt Screed Warranty .....	21
Unit Identification .....	23

## **Introduction**

Congratulations on your purchase of the Batt Screed 6000.

The Batt Screed is proudly manufactured in the USA by Curb Roller Manufacturing. The Batt Screed has been manufactured to provide years of service.

Before using the Batt Screed you must read and follow this manual for proper use and set up. If using the Lynx System with the Batt Screed, reference the Lynx Screed System manual.

## **Upon Receipt**

Carefully examine your equipment upon receipt to verify all the components of your order have been shipped to you and arrived undamaged. Report any damage immediately to the freight carrier and register any claim. If any material or manufacturing defects are discovered, contact a Curb Roller Mfg. representative at 785-467-3132.

## **Manufacturer's Notice**

Information provided in this manual was current as of the issue date. Curb Roller Mfg. reserves the right to make design changes without notice or liability.

Information furnished in this manual does not include all of the details of design, production, or variations of the equipment. It does not cover all of the possible contingencies which may emerge during operation. If special problems arise or further information is desired, please contact a Curb Roller Mfg. representative at 785-467-3132.

This owner's manual does not replace, nor does its use release the owner/operator from observing all safety codes or operating limitations as well as any applicable federal, state, provincial or local regulations.

## Specifications

Length

33" (838 mm)

Width

19" (483 mm)

Weight

75 lbs (34 kg)

## Batt Screed Package

This package may include:

- A. Drive Unit
- B. T-Bar Assembly
- C. Two (2) Expandable Pipe Ends
- D. Two (2) DeWalt Batteries
- E. DeWalt FLEXVOLT Charger
- F. Pull Bushing

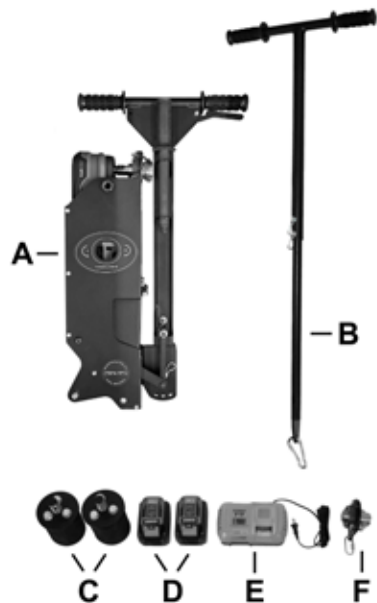

\* Pipe and Lynx Screed System are sold separately. If buying pipe from outside source, Curb Roller Mfg. recommends using aluminum pipe:

6061-T6 EXTRUDED PORTHOLE PIPE - ASTM B429 - 4" SCH 40 (4.500 OD X .237 W)

## Safety

Before assembling and operating this equipment you must read, understand, and follow the instructions and safety warnings in this manual.

If you have any safety concerns or questions that are not covered in this manual, please contact a Curb Roller Mfg. representative at 785-467-3132.

### **⚠ WARNING**

**Failure to read and obey the following safety warnings may result in serious injury or death.**

### **⚠ WARNING**

The use of the Batt Screed may be hazardous. The Batt Screed has rotating parts and lithium-ion battery power.

### **⚠ WARNING**

Do not alter, change, or modify the Batt Screed. Altering, changing, or modifying the equipment may cause unsafe conditions or damage the equipment, and may void the manufacturer's warranty.

### **⚠ WARNING**

Observe all federal, state, provincial, and local safety codes and regulations that apply to the job site.

### **⚠ WARNING**

Do not operate the Batt Screed if you are too tired or if you have a medical condition that might be aggravated by strenuous work.

### **⚠ WARNING**

Always transport the Batt Screed with the batteries removed from the drill to avoid any accidental rotation or power loss.

### **⚠ WARNING**

Do not operate, work on/or around this machine while under the influence of alcohol, drugs, or if feeling ill.

### **⚠ WARNING**

Never attempt to clean or service the Batt Screed while the machine is running. Always clean and maintain the Batt Screed with the batteries removed from the drill to avoid accidental rotation.

**⚠ WARNING**

Before each use charge all batteries and inspect all moving parts for concrete or other debris that may hinder smooth operation.

**⚠ WARNING**

The Batt Screed is designed to run with the drill on low speed. Do not under any circumstance take apart the drive unit and change the speed on the drill.

**⚠ WARNING**

Do not install battery until the drive unit is hooked up to the pipe insert and hands and fingers are away from the chuck and any moving parts.

**⚠ WARNING**

Make sure the second operator has a good hold on the opposing t-bar handle attached to the pipe.

**⚠ WARNING**

Entanglement hazard. Keep away from moving parts.

**⚠ WARNING**

Make sure everyone around the pipe is aware the pipe is about to spin.

**⚠ WARNING**

Do not wear jewelry, headsets with dangling wires, or coats with dangling hood strings.

**⚠ WARNING**

Never operate machine with missing guards, shields, bolts, pins, or any missing part.

## Assembly

1. Push expandable insert into the end of the pipe until flange is tight against pipe end. NOTE: If using the Lynx Screed System, skip to step 5.
2. If using SCH 40 pipe, make sure the pipe ends have been cut true and are not angled. Ends not properly cut will cause excessive shaking and may cause damage to the drive unit. Use a factory cut end of the pipe whenever possible to install the drive end on. This will ensure against excessive wobble and shaking.

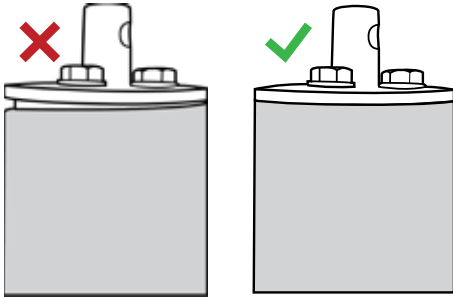

3. Equally tighten the lug bolts on the expandable pipe inserts to ensure proper fitting into pipe using a  $\frac{3}{4}$ " ratcheting socket, wrench, or preferably a battery impact.

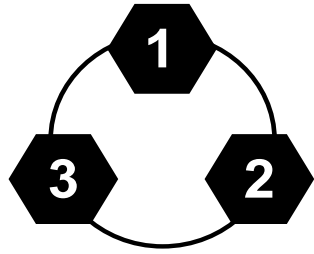

4. Repeat steps 1 and 3 with the other expandable pipe insert.
5. Make sure the battery is removed from the machine to protect the operator in case of accidental trigger activation. Lay the drive unit down next to the pipe or Lynx Screed System and align the chuck to the shaft.
6. Push drive head all the way onto the shaft. Take one hand and roll the pipe forward until you can see down through the chuck and shaft hole. Once you have the two holes aligned install the lock pin.

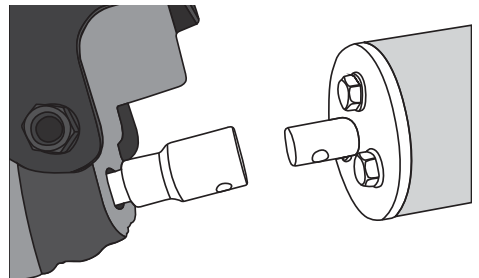



- Attach the pull bushing to the idle end.
- Connect T-Bar handle to the pull bushing.

## Operation

- Remove pin from the handle and fold out away from the drive unit. Replace pin when handle is in the desired operating position.

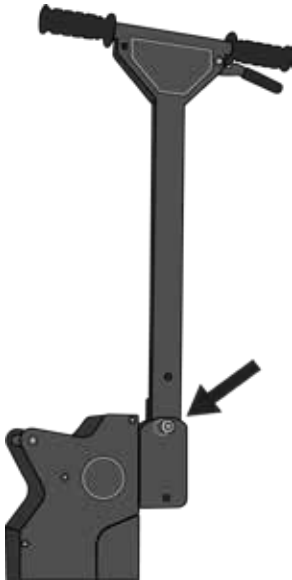

- Open battery access door and insert charged DeWalt FLEXVOLT battery.

- With both operators holding the handles, lightly pull the variable speed trigger to see which direction the pipe or Lynx Screed System turns.

- If the pipe or Lynx rotates towards the operators, change the rotation by pushing the directional button.

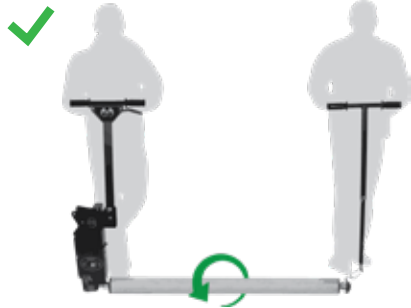
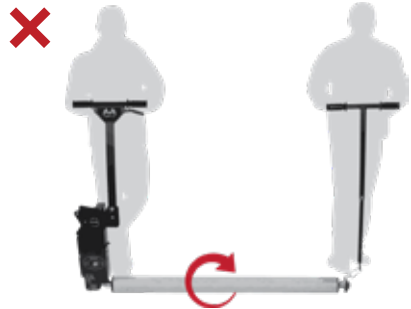

- Once spinning direction is correct, the operator on the drive side can squeeze the speed trigger. Both operators should walk backwards in tandem to begin screeding.

## Operation Technique

1. The operators should screed off a section quickly with the trigger fully pulled, then return to the sections' start point.
2. Raker(s) work to fill in any voids and assist in concrete distribution.
3. Make at least two more passes, with the final pass being slower than the first two.

## Cleanup and Maintenance

### Cleanup

1. Move the Batt Screed away from poured concrete.
2. Run the machine in nearby grass or along the ground while spraying with water.
3. Excess wet concrete may be removed with a rag, wire, or bristle brush.
4. Gently remove dry concrete using a scraper or similar tool.

### Maintenance

Charge all batteries before each use.

If using expandable pipe inserts, remove after each pour and store in the non-compressed position.

Remove the bolts from the expandable ends and re-apply a coat of anti-seize on them at least once a year.

## Troubleshooting

### Trigger Sticks

- Check bolt on handle and loosen nylon nut if necessary.

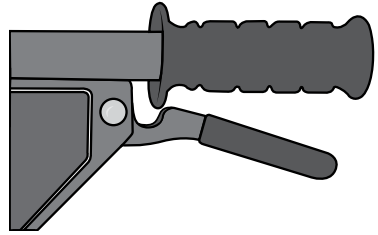

- Check slide for concrete build up.
- Check trigger and linkage for bent parts or concrete build up.

### Short Battery Life

- Low slump concrete or sand.
- Excessive concrete in front of roller.
- Old, defective, or not properly charged battery.

## Excessive Shaking or Pipe Jumping

- Check to see if pipe is bent.
- Check if the drive end of pipe is cut off at an angle.

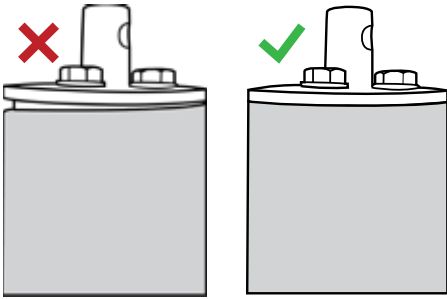

- Verify the pipe insert is installed properly and not at an angle.
- Avoid abrupt or excessive left or right movement of the drive unit to reposition pipe.

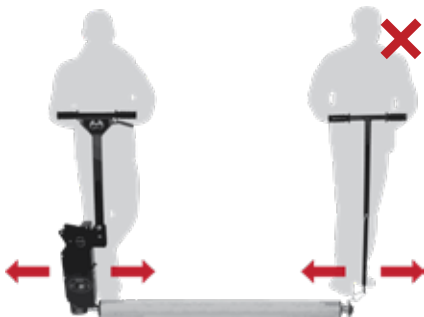

- Make sure forms are level.

## Access Door Won't Stay Shut

- Tighten door bolt.

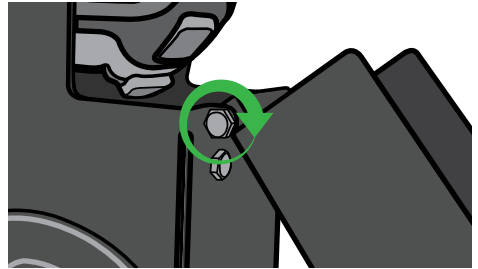

## Drive End Falls In Concrete / Won't Stand

- Install the handle/kickstand supplied with screed in opposing mounting nut.

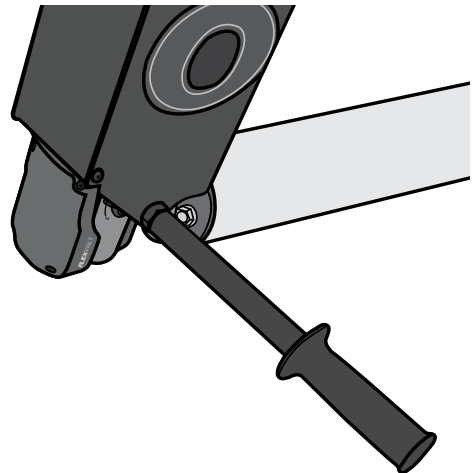

## Nothing Happens When Trigger Is Pulled

- Check battery life by pressing indicator button.
- Remove battery and reinsert.

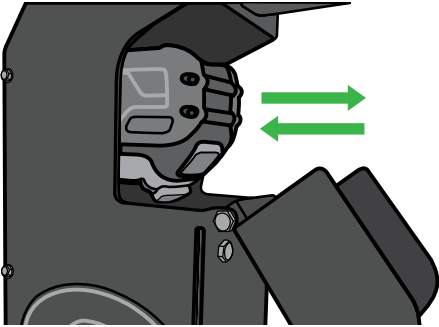

- Check all linkage for proper activation of drill trigger.
- Check directional button and make sure it is depressed all the way in.



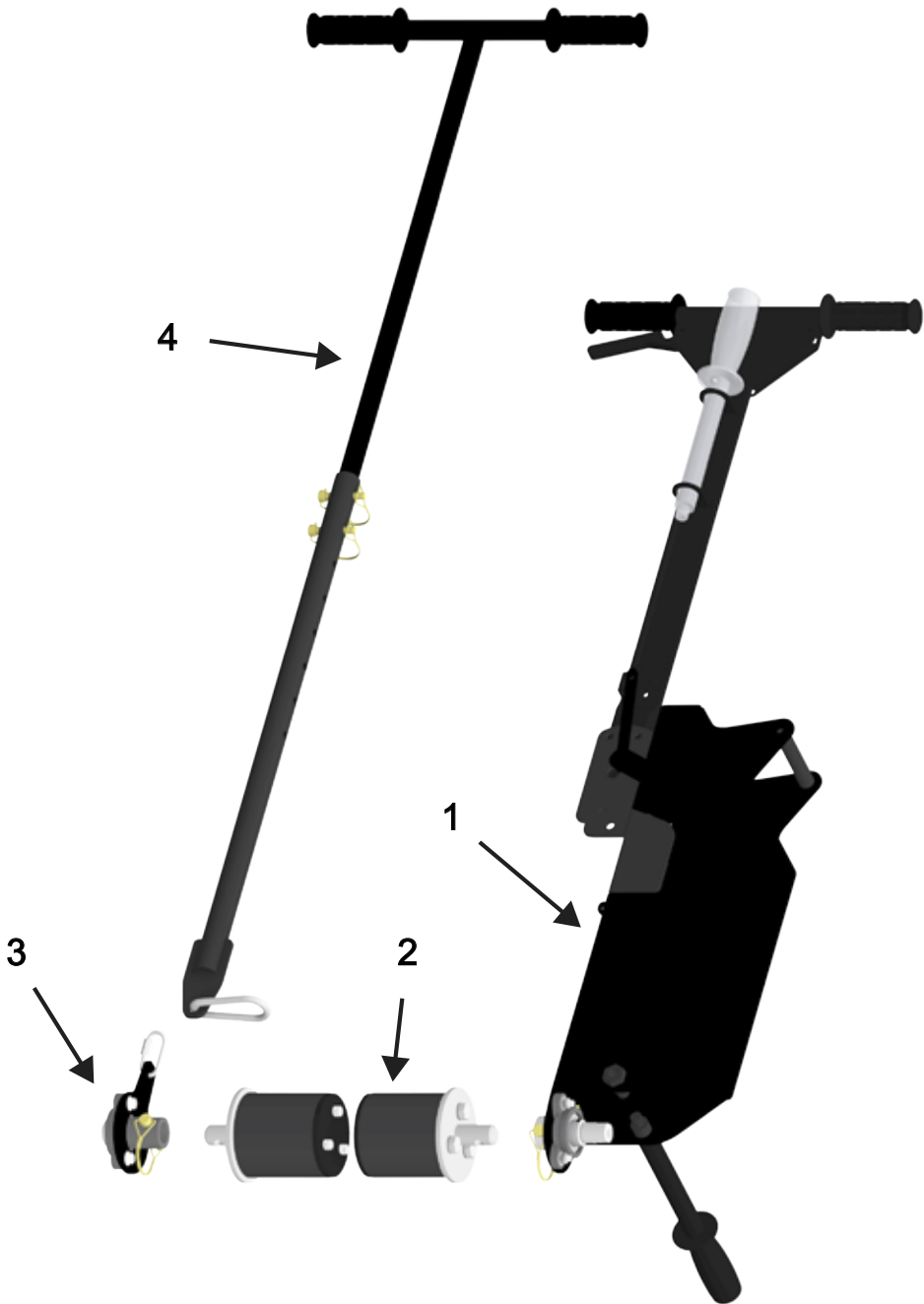

## Parts

No.	Qty.	Description	Part No.
1	1	Unit Assy-Base, BTA6000	60100-001
2	2	Bushing Assy-4" Pipe, Batt Screed 6000	60501-001
3	1	Connector Assy-Pull, BS6000/ES6100	60503-001
4	1	Handle Assy-Pull, Black	60019-001

### Items Not Shown

	Qty.	Description	Part No.
	2	Battery-DeWalt, 60V, 12 AmpHour	1500-031
	1	Charger-Dewalt, 20V Max (120V/60Hz)	1500-051
	1	Manual Kit-BTA6000	19001-005

### Other Machine Variations Include

		Description	Part No.
		240v/50hz	60900-003
		w/o Hubs/Battery	60900-005
		120v/12ah (w/o Hubs)	60900-007
		w/o Battery/Charger	60900-009
		120v/9ah	60900-011
		Drive Only	60900-013
		120v/9ah (w/o Hubs)	60900-017

\*Assembly items broken down on following pages

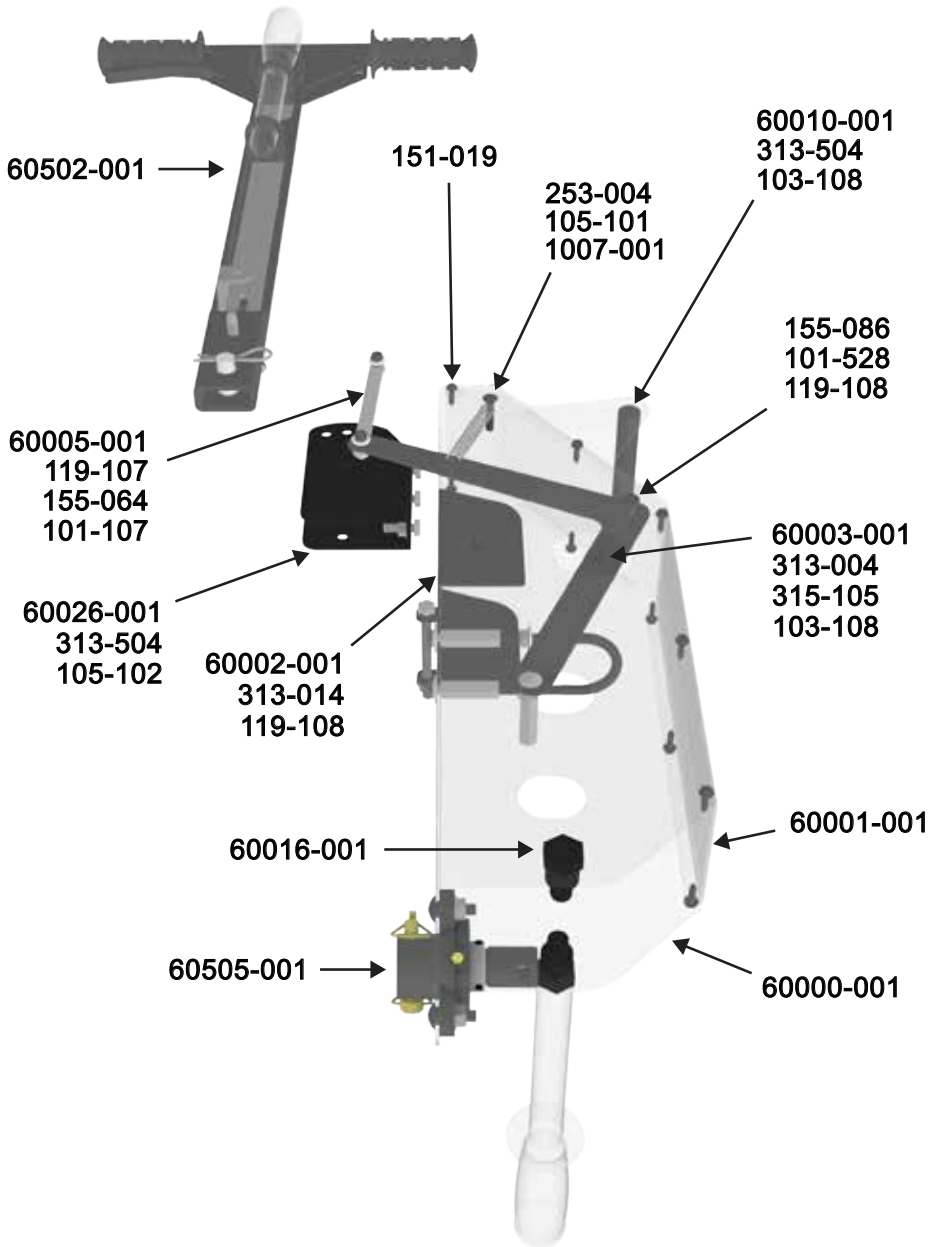



# Parts

## Unit Assy - Base BTA6000 60100-001

Qty.	Description	Part No.
1	Handle Assy-Control, Batt Screed 6000	60502-001
10	Screw-Self Tap, HWH, #10 x 3/4", Zc Pltd	151-019
1	Bolt-Crge, 1/4"-20 Unc x 1", Zc Pltd	253-004
1	Nut-Lock, Srrtd Flg, 1/4", Zc Pltd	105-101
1	Spring-Extension, 0.437ODx2.00Lgx0.063 Wire, Zc	1007-001
1	Handle-Lift, BS6000 (0.75" OD x 4" Lg)	60010-001
2	Bolt-HCS, 5/16"-18 UNC X 1", Zc Pltd	313-504
2	Washer-Lock, 5/16", Zc Pltd	103-108
1	Bolt-Shldr, Allen, 3/8" x 1/2", 5/16"-18 Unc	155-086
2	Washer-Nylon, 1/2", 0.50"ID x 1.25"OD x 0.62 Thk	101-528
1	Nut-Nylock Hx, 5/16"-18, Zc	119-108
1	Arm-Pivot, "90^" (Yoke x Trigger)	60003-001
1	Bolt-Crge, 5/16"-18 UNC x 1", Zc Pltd	313-004
1	Nut-Cplg, 5/16"-18 UNC x 1-3/4", Zc Pltd	315-105
1	Washer-Lock, 5/16", Zc Pltd	103-108
1	Housing-Rear, BS6000	60001-001
1	Housing-Front, BS6000	60000-001
1	Mntng/Drive Assy-BTA6000	60505-001
2	Nut-Mounting, Dewalt, Replacement	60016-001
1	Door-Access, Battery	60002-001
1	Bolt-HCS, 5/16"-18 x 3-1/2", Zc	313-014
1	Nut-Nylock Hx, 5/16"-18, Zc	119-108
1	Bracket-Positioning, BS6000/ES6100	60026-001
3	Bolt-HCS, 5/16"-18 UNC X 1", Zc Pltd	313-504
3	Nut-Lock, Srrtd Flg, 5/16"-18 UNC, Zc Pltd	105-102
1	Arm-Link, Speed Control	60005-001
2	Nut-Nylock Hx, 1/4"-20, Zc	119-107
2	Bolt-Shldr, Allen, 5/16" ODX3/8", 1/4"-20 Unc	155-064
4	Wshr-Flat, 1/4", SAE, Zc Pltd	101-107

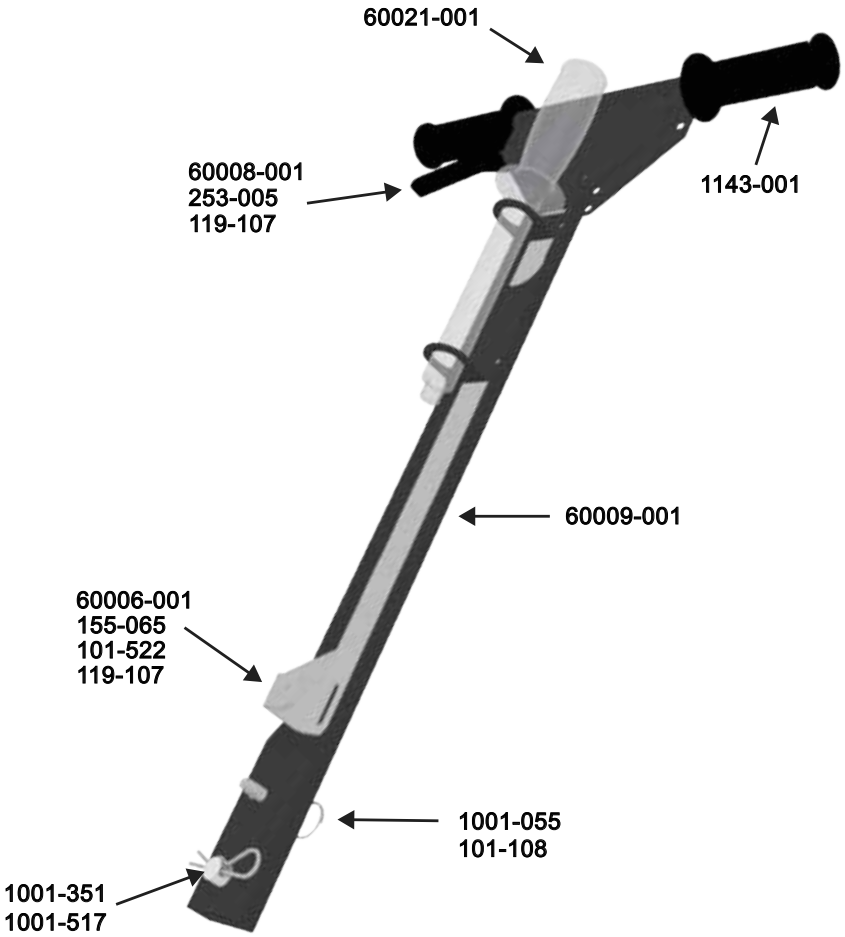

# Parts

## Handle Assy - Control BTA6000 60502-001

Qty.	Description	Part No.
1	Handle-Side, Replacement, Dewalt Drill	60021-001
2	Grip-Handle, Rbbr, 1" ID x 1.63" OD x 4.75 OAL	1143-001
1	Slide	60006-001
1	Pin-Detent, 0.375" x 1.50"	1001-055
1	Washer-Flat, 5/16", SAE, Zc Pltd	101-108
1	Pin-Clevis, 5/8" x 1.50" OAL (1.25" EL)	1001-351
1	Pin-Bridge, 0.125" Dia x 2.56" OAL, Zc Pltd	1001-517
1	Handle Wdmt-Control, BS6000	60009-001
1	Bolt-Shldr, Allen, 5/16" x 1/2", 1/4"-20 Unc	155-065
2	Washer-Nylon, 5/16", 0.34"ID x 0.88"OD x 0.06 Thk	101-522
1	Nut-Nylock Hx, 1/4"-20, Zc	119-107
1	Lever-Control, Speed	60008-001
1	Bolt-Crge, 1/4"-20 UNC x 1-1/4", Zc Pltd	253-005
1	Nut-Nylock Hx, 1/4"-20, Zc	119-107

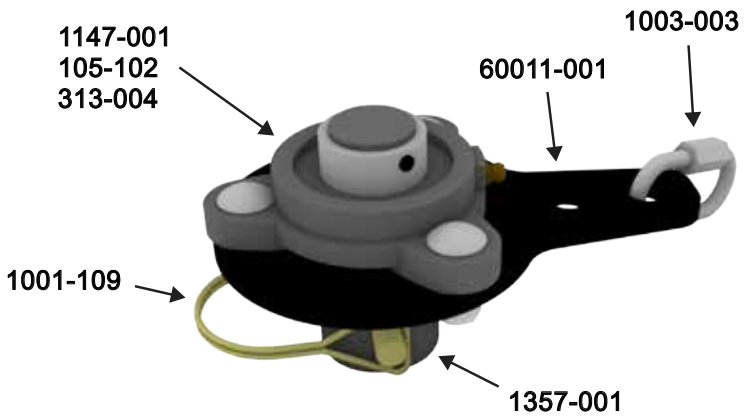
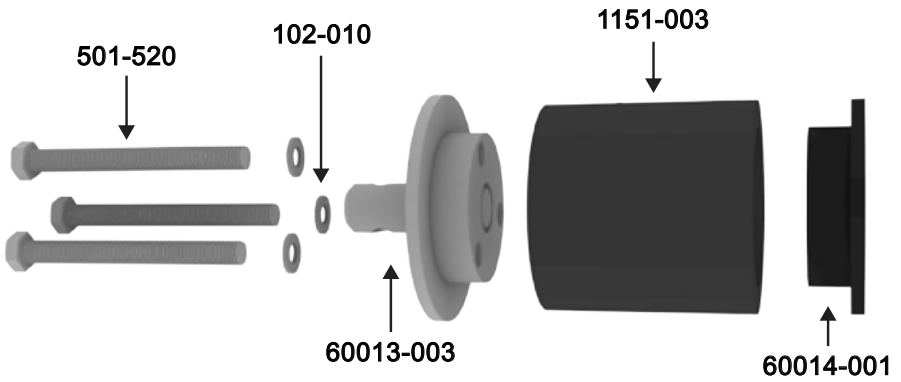
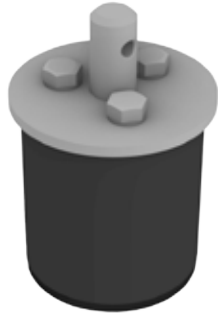

## Parts

### Bushing Assy - 4" Pipe 60501-001

Qty.	Description	Part No.
3	Bolt-Tap, 1/2"-13 x 5", UNC, Zc Pltd, G5	501-520
3	Wshr-Flat, M12, 8.8, Zc	102-010
1	Flange Wdmt-Rtng, Outside, 4" SS	60013-003
1	Bushing-Expansion, Rbbr, 4"	1151-003
1	Flange-Rtng, Inside, 4" Pipe	60014-001

### Connector Assy - Pull 60503-001

Qty.	Description	Part No.
1	Bearing-Flgd, 3-Bolt, 1" ID	1147-001
3	Nut-Lock, Srrtd Flg, 5/16"-18 UNC, Zc Pltd	105-102
3	Bolt-Crge, 5/16"-18 UNC x 1", Zc Pltd	313-004
1	Plate-Pull, Static End	60011-001
1	Link-Cnctng, Qk, 1/4", Zc Pltd	1003-003
1	Coupler-Static End, BS6000/ES61000 (SS)	1357-001
1	Pin-Lock, 3/8" Rd, Dbl Wire, 1-3/4" Eff Lg, Zc Plt	1001-109

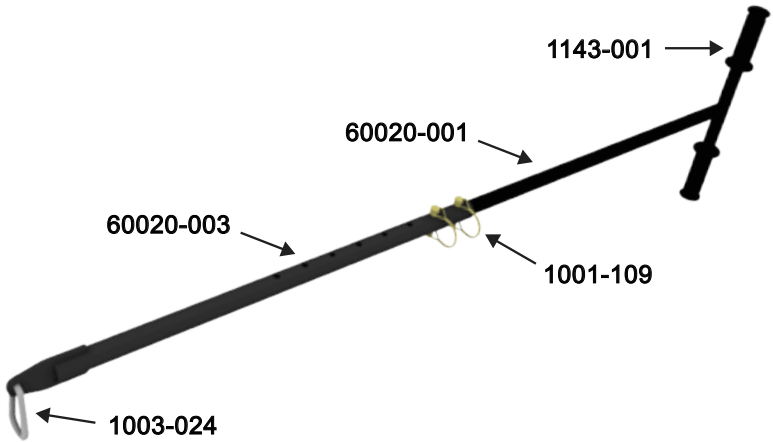
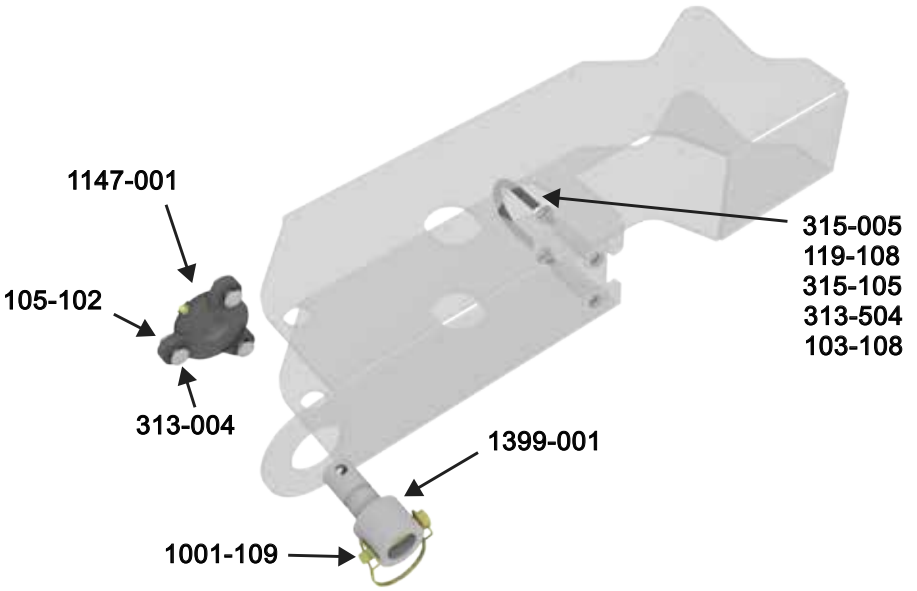

# Parts

## Mntng / Drive Assy BTA6000 60505-001

Qty.	Description	Part No.
1	Bearing-Flgd, 3-Bolt, 1" ID	1147-001
1	UBolt-Rd, 5/16"-18 Unc, 1-3/4" W x 4-1/4" L, Zc P	315-005
2	Nut-Nylock Hx, 5/16"-18, Zc	119-108
2	Nut-Cplg, 5/16"-18 UNC x 1-3/4", Zc Pltd	315-105
2	Bolt-HCS, 5/16"-18 UNC X 1", Zc Pltd	313-504
2	Washer-Lock, 5/16", Zc Pltd	103-108
1	Chuck-Drive, Brg Sprt	1399-001
1	Pin-Lock, 3/8" Rd, Dbl Wire, 1-3/4" Eff Lg, Zc Plt	1001-109
3	Bolt-Crge, 5/16"-18 UNC x 1", Zc Pltd	313-004
3	Nut-Lock, Srtd Flg, 5/16"-18 UNC, Zc Pltd	105-102

## Handle Assy - Pull 60019-001

Qty.	Description	Part No.
1	Handle Wdmt-Lower (Black)	60020-003
1	Handle Wdmt-Upper (Black)	60020-001
2	Grip-Handle, Rbbr, 1" ID x 1.63" OD x 4.75 OAL	1143-001
2	Pin-Lock, 3/8" Rd, Dbl Wire, 1-3/4" Eff Lg, Zc Plt	1001-109
1	Link-Snap, 3/8", Zc Pltd	1003-024

## **Batt Screed Warranty**

Curb Roller Mfg. warrants to the original purchaser that this product will be free from defects in material and workmanship.

Curb Roller Mfg. agrees to repair or replace, at manufacturer's discretion, any defective product free of charge within one year from the date of purchase.

Curb Roller Mfg. must authorize all work and returns prior to any work being performed or returns made. If the customer does perform work and makes a return without authorization, the customer does so with the understanding that Curb Roller Mfg. or any of its agents shall not be obligated for the cost of any such unauthorized expenses or actions.

Proof of purchase in the form of your dated sales receipt showing serial number and the model of the product will be required before our dealers can perform warranty service on the product.

All allowances will be credited at factory cost with no provisions for overtime, travel time, mileage, freight charges, or special services (i.e. down time).

The purchaser of any goods covered by this warranty

understands and agrees that the sole and exclusive remedy against Curb Roller Manufacturing shall be for the replacement or repair of defective goods as provided herein.

**Machine is warranted for a period of one (1) year after date of original purchase to original purchaser.**

**Batteries are warranted for a period of three (3) years after date of original purchase to original owner.**

### **NOTICE**

Curb Roller Manufacturing product warranty shall not extend or apply to:

1. Defects which in our judgment are the result of misuse, negligence, accident, or failure to perform regular maintenance or service, and any parts that may wear and need to be replaced.
2. Products and component parts not manufactured by Curb Roller Manufacturing beyond the warranty period provided by the original manufacturer or supplier.
3. Products improperly installed, maintained, or used not in accordance with all applicable



Curb Roller Manufacturing  
instructions.

4. Goods or component parts that are modified or changed in any way other than by, or authorized by, Curb Roller Manufacturing.

Warranty questions or service information can be obtained from your dealer or by contacting Curb Roller Manufacturing at 785-467-3132 .

Please visit [www.curbroller.com](http://www.curbroller.com) to register your product.

## Unit Identification

An identification sticker listing the serial number is attached to each unit. This sticker should not be purposely removed at any time.

Please record your machine information below so it will be accessible should the identification sticker become lost or illegible.

When ordering parts or requesting service information, these details can help us process your inquiries faster.

Model Number: \_\_\_\_\_

Serial Number: \_\_\_\_\_

Date Purchased: \_\_\_\_\_

Purchased From: \_\_\_\_\_





Curb Roller Mfg., 112 South Main Street, Fairview, KS 66425

US Patents: 10837147B2, 10844554B2, 10844555B2  
February 2023